



CASE STUDY

Williams-Scotsman is a leader in the sale and distribution of modular and mobile buildings for temporary and permanent use. Their offices are throughout North America, serving a national clientele. Williams had expanded operations significantly over the past 20 years. They had outgrown their original offices and needed additional space to service its national network of clients. They required a modular building of the first quality to showcase the state-of-the-art possibilities offered with modular systems. The building would be seen on marketing materials, on their web site, and would be pointed to as the quintessential example of their product and the possibilities of modular construction.

KEY ACHIEVEMENTS

85% of construction was finished off-site.

Saved man hours and excessive building material waste.

Completed over 35,000 square feet

No disruption to existing business activities around construction site.

Less environmental impact.

Flexible design for new multiple departments and functions

WILLIAMS SCOTSMAN CORPORATE OFFICE

The initial building was 35,000 square feet with a stucco exterior, a curved facade and bent windows. It presented a sleek, modern look to visitors. The foyer was finished in marble, chrome, tile, architectural glass and exotic woods. The interior presented an image of sophistication and permanence to further impress potential customers. Later, two additional wings were added to house a growing staff. These three story wings added an additional 35,000 square feet, for a total of 70,000 square feet of floor space. Electrical work was included to power the new computer equipment and server technologies in the addition.



Williams Scotsman Corporate Office

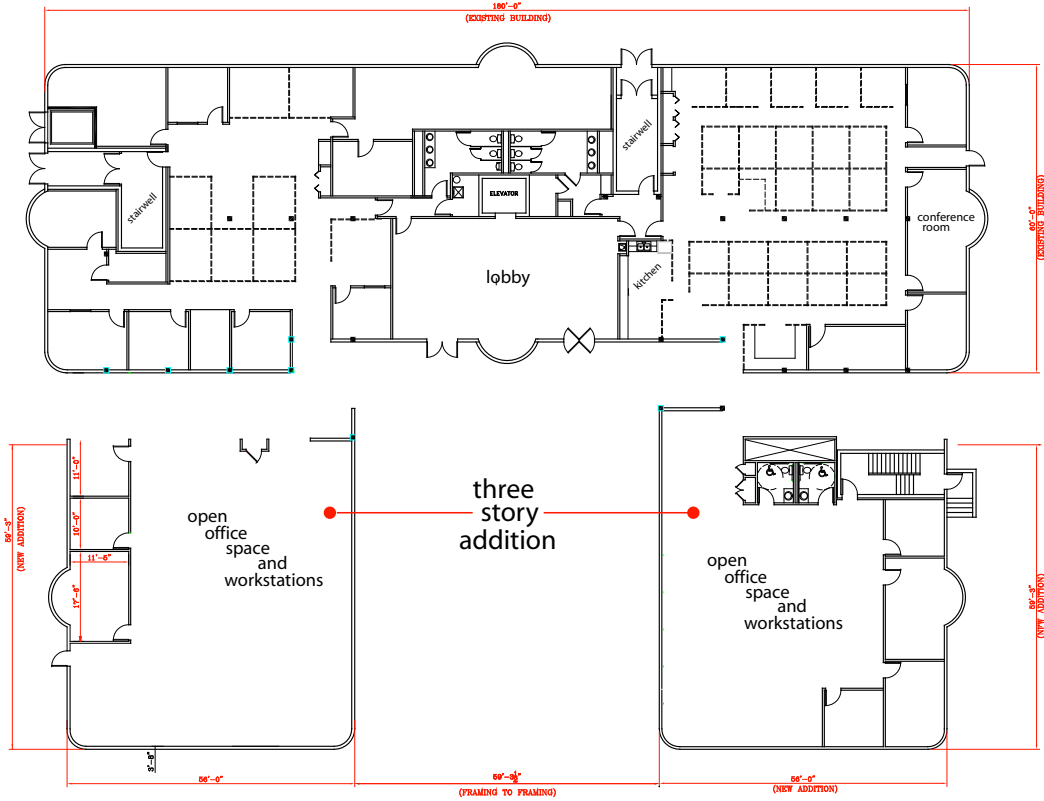

1ST OF 3 FLOORS IS SHOWN



KEY FACTS

PROJECT NAME
WILLIAMS SCOTSMAN
CORPORATE OFFICE ADDITION

LOCATION
BALTIMORE, MD

PARTNERS
WILLIAMS SCOTSMAN

PROJECT TYPE
PERMANENT STRUCTURE,
CORPORATE OFFICE

BUILDING SIZE
35,000 SQ. FT.
THREE FLOORS

BUILDING UNITS
49 MODULES



Conference Room

Lobby

Serving you nationwide from South Whitley, IN (260) 723-5131 • Rochester, IN (574) 223-4934 • Marysville, WA (360) 653-5790 & Leola, PA (717) 656-2081 • Visit us online at www.whitleyman.com