



CASE STUDIES · EDUCATION



CHARTER SCHOOL		Project Duration	8 Months
Cesar-Chavez School		Partners	Innovative Modular Solutions Naperville, IL Lee Stevens Architects Port Huron, MI
Detroit, Michigan			
Cesar-Chavez is a new charter school formed in Detroit. The charter serves a predominantly Latino population base and was formed to instill a sense of community, as well as encouraging academic and social pride amongst an at-risk youth population		Specs	35,000 Square Feet Two-Stories Office and Classroom Space



“The building is an inspiration to the neighborhood.”
-Patrick Irwin
School Board Pres.



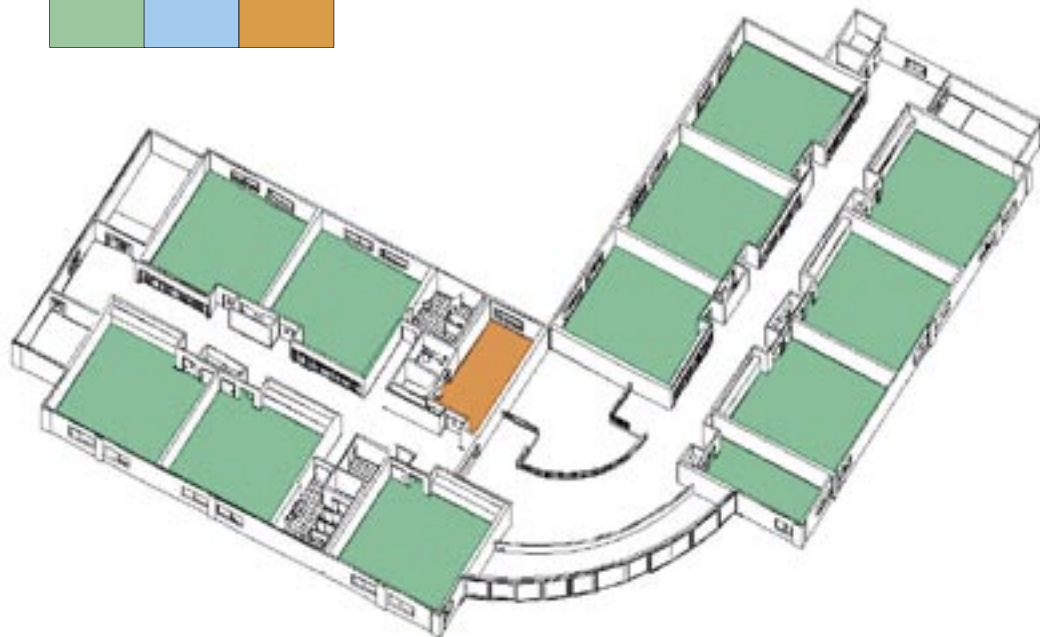
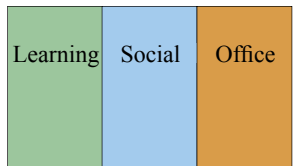
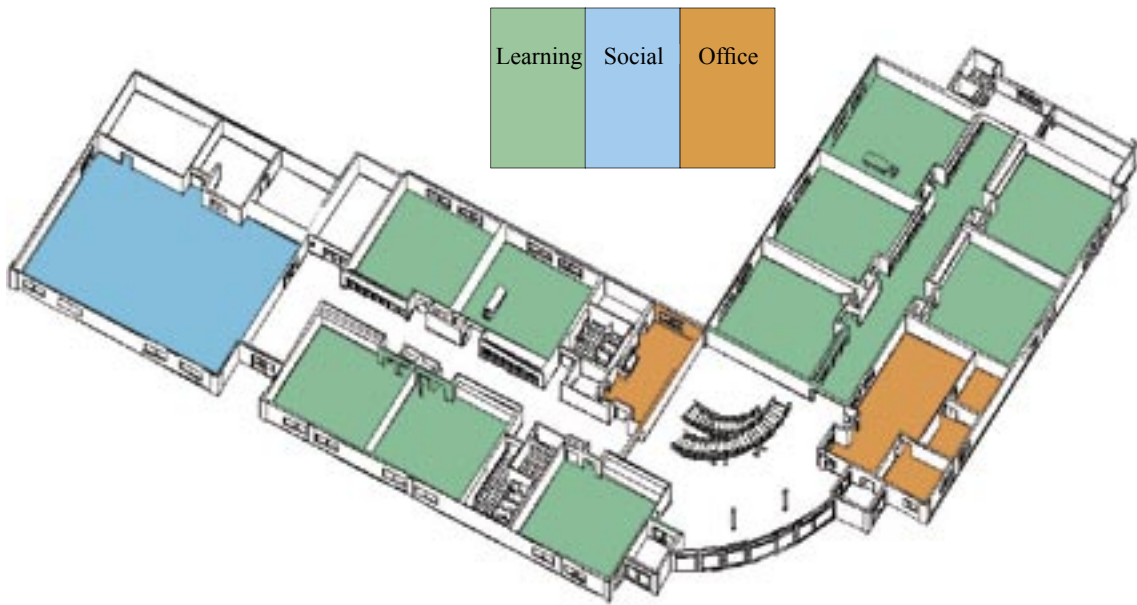

THEIR NEED

In February of 2005, Cesar Chavez saw an opportunity. They were paying high rent for space in a poorly retrofitted warehouse. They wanted an alternative that would provide a prime educational setting within the span of a few short months. Initially, they doubted that modular construction could provide the modern aesthetic that their urban surroundings demanded.

OUR SOLUTION

Our distributor (Innovative Modular Solutions), told the Chavez board, to their surprise, that a new building could be ready in time for the fall semester. A new school would save a year's rent and could be custom designed to facilitate their unique educational goals. In a few short years, the building would have paid for itself in rent savings alone. The presentation drawings prepared by Whitley and Lee Stevens Architects allowed the board to "see" their new building and modify it to best suit their needs.

Whitley and Lee Stevens (AIA), were able to design and build a 35,000 square foot, two-story facility with ample classrooms, a suite of offices, ceramic lavatories, recessed lockers, storage spaces, an efficient heating system, and a cafeteria that met the demands of the board. We constructed the building, completed the site, and finished the interior within eight months. ***The building now evokes pride in the neighborhood and in children who attend the gleaming facility.***