



CASE STUDY

Founded in 1947, PFCU has approximately 10,000 members throughout southeastern Michigan. Parkway offers a full range of financial services to member groups associated with some of the biggest names in the Detroit automobile industry.

When parkway's largest employer membership group opened a second plant at a distant location management at first felt members could still be served from their original facility. Unfortunately, the 25 mile distance began costing Parkway customers to other credit unions and was faced with losing the entire employee group.

KEY ACHIEVEMENTS

Completed in 120 Days!

Structure built to specified design criteria and security measures

Architectural materials give an attractive and permanent appearance

Off-site construction eliminated disruption to local businesses

ADA compliant restrooms

Construction time line cut by 25% by utilizing modern building techniques

PARKWAY CREDIT UNION michigan

The building was needed quickly, on budget, and with a modern design. Prices for site built construction were high and the one year turnaround time was unacceptable. Parkway chose Whitley Manufacturing for the construction. Within 120 days the bank was completed, and the facility has been impressing customers and employees ever since. The building was fitted with a site-applied brick exterior, quoin corner trim, and a pitched roof with a standing seam metal covering.

Parkway Credit Union

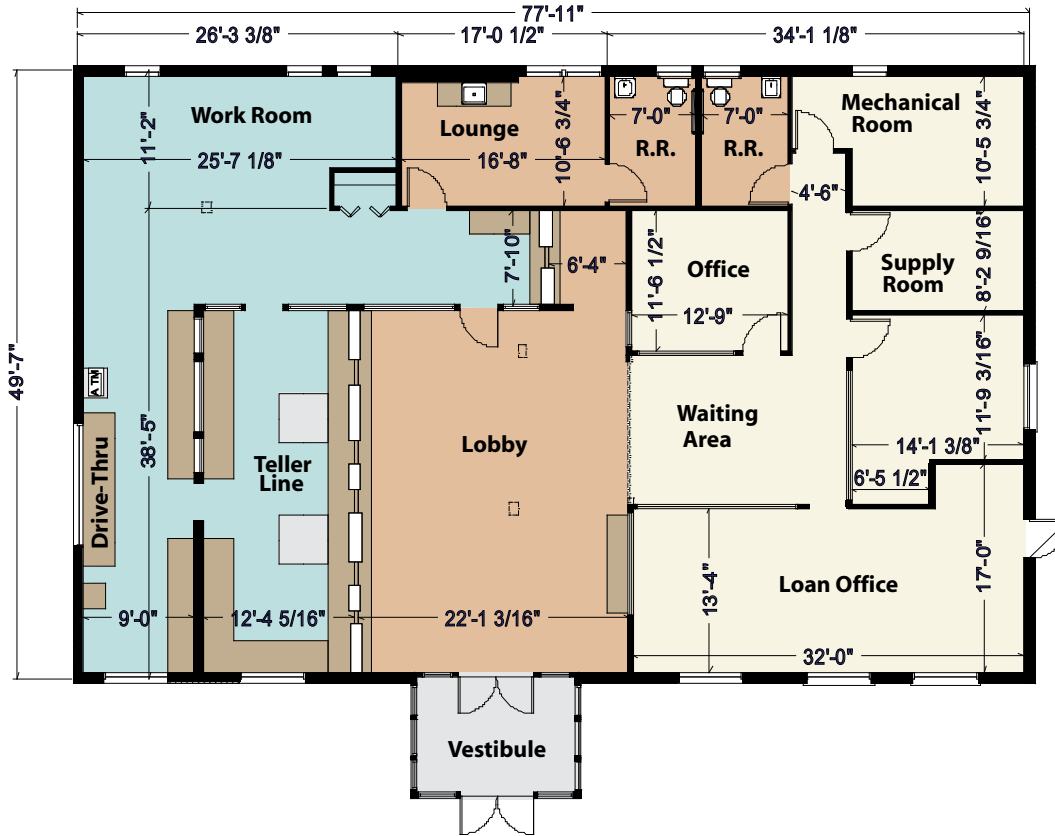

Accelerated production process can dramatically reduce overall project time line.

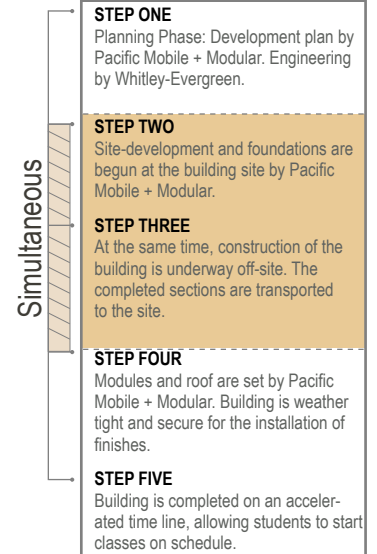

KEY FACTS

PROJECT NAME
PARKWAY CREDIT UNION

LOCATION
ROMULUS, MICHIGAN

PARTNER
SON CORPORATION

PROJECT TYPE
CUSTOM MODULAR BANK

BUILDING SIZE:
3,900 SQ. FT.

UNITS:
6 MODULES

