



SHORELINE, WA MUSIC CLASSROOMS



Location Shoreline, WA

Partners Williams-Scotsman
Broweleit, Peterson, Hammer Arch.

Type Permanent School Building

Size Total: 3,320 square feet

Units 8 Freestanding Buildings

Client The Shoreline School District of Washington State was expanding their music education program offerings and was in need of facilities to accommodate the expanded program.

Their Need The school wanted to provide facilities that provided an upscale aesthetic appearance but retained flexibility for relocation or expansion should their demographics + enrollment change.

Our Solution The buildings utilized a combination of standard modular construction and factory-built pitched roof sections and clerestory windows to enhance daylighting and interior volume. The building's feature a solid floor structure composed of strategically supported cement board.

The vertical spaces in the classrooms were also designed to optimize acoustics for the music programs to be housed within.

The building's also feature a unique site-finished front entry canopy that is an extension of the factory built roof sections. The building's feature a grade-level entry that eliminates steps & ramps. All eight buildings utilize a similar board and batten exterior with a variety of color schemes that blend seamlessly with the existing campus structures.



Construction begins on the (8) freestanding Music Program Bldgs.

PROJECT START.

Modular and site-built areas all completed and classrooms are ready for students.

94 DAYS LATER.

The eight buildings feature sloping roofs + clerestory windows and a board + batten exterior in several color combinations.

AESTHETICS.

The building's feature substantial floor structures and foundations with concrete board floor decking surfaces for solidity.

QUALITY.

All (8) buildings are designed to allow for potential relocation or re-purposing as demographics and enrollments change + evolve.

FLEXIBILITY.

Shoreline S.D. Music Program Classes

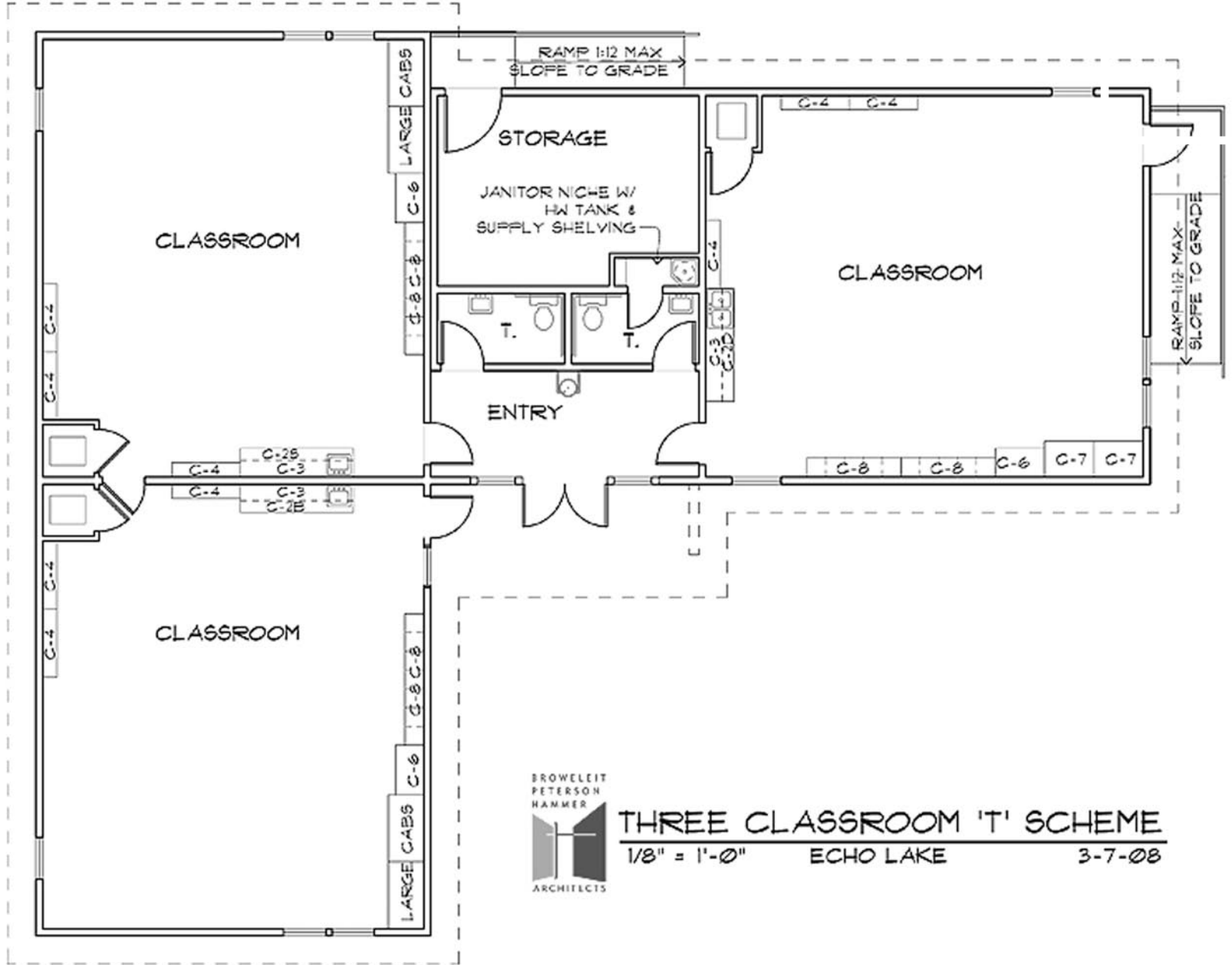

THREE CLASSROOM 'T' SCHEME

1/8" = 1'-0" ECHO LAKE 3-7-08



Whitley Mfg. Co., Inc.
 South Whitley, IN // Rochester, IN
 Marysville, WA
 (260) 723-5131
 www.whitleyman.com

FEATURES

Exterior Covering: Board and batten exterior with colors selected to match existing structures.

The building features a solid floor structure and foundation system with cement board decking.

Building interior spaces and volumes are optimized for acoustical performance.

Building's were designed to allow for possible relocation and re-purposing.

The buildings feature a unique combination of standard modular units and factory-built pitched roofs and clerestory windows to provide vertical height throughout the interior and increase daylighting.