

# WHITLEY MANUFACTURING



**FOR:** DaVita  
LaGrange, KY

**TYPE:** Medical  
Dialysis

**WITH:** MedBuild  
(Resun Corp.)

DaVita corporation contacted Whitley Manufacturing and MedBuild, when site contractors could not meet their aggressive construction schedule. Whitley completed construction while MedBuild prepared the site. After setting the components, MedBuild applied brick and constructed a pitched roof. The 5,000 sq. ft. building with was finished in less than 100 days.

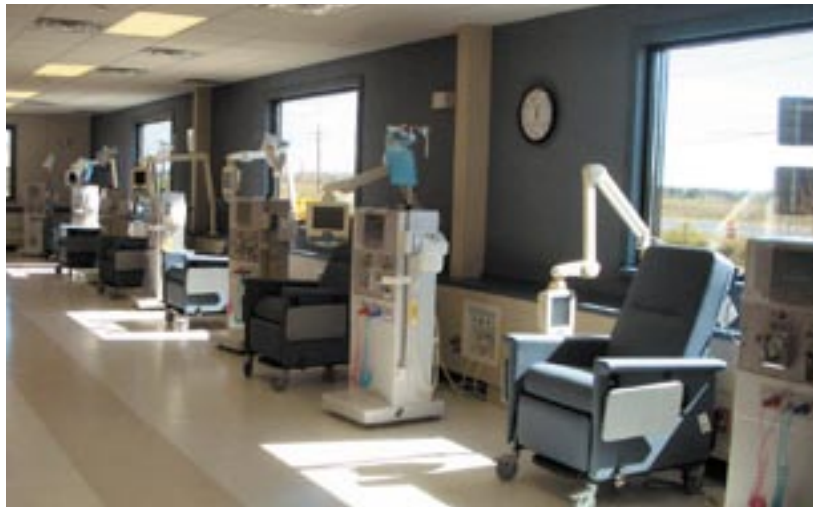
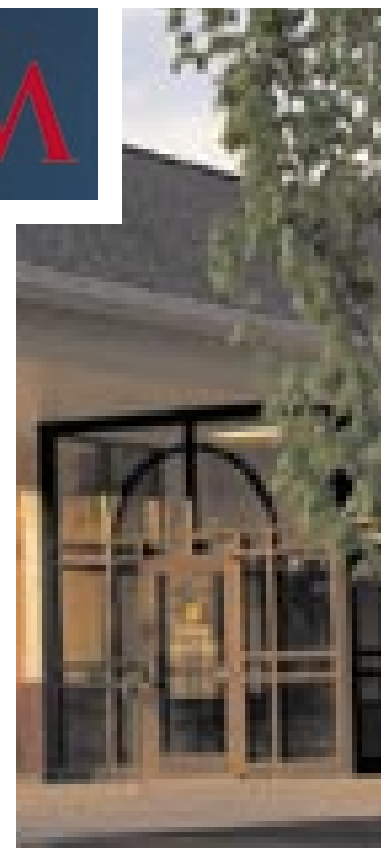



**WHITLEY  
MEDICAL**

- Dialysis
- MRI
- Hospital
- Clinic
- Medical Office
- Dental

## THEIR NEED

Part of DaVita's growth plan included a new facility in LaGrange, Kentucky. Their contractors at the site told them that they could not meet the aggressive schedule. It was late November and the company needed the 5,000 square foot facility open by mid-March. DaVita chose to contact modular medical specialists, MedBuild, and the nation's premier modular builder, Whitley Manufacturing.

## OUR SOLUTION

Whitley had fewer than 60 days to ship the dialysis clinic; complete with many exacting specifications and systems. The design needed to be finalized, permits acquired, materials ordered, ground prepared, and construction completed. Even with the holidays looming, Whitley shipped the building components and MedBuild completed the finished brickwork and pitched roof, allowing the building to open on schedule, less than 100 days after the beginning of construction.

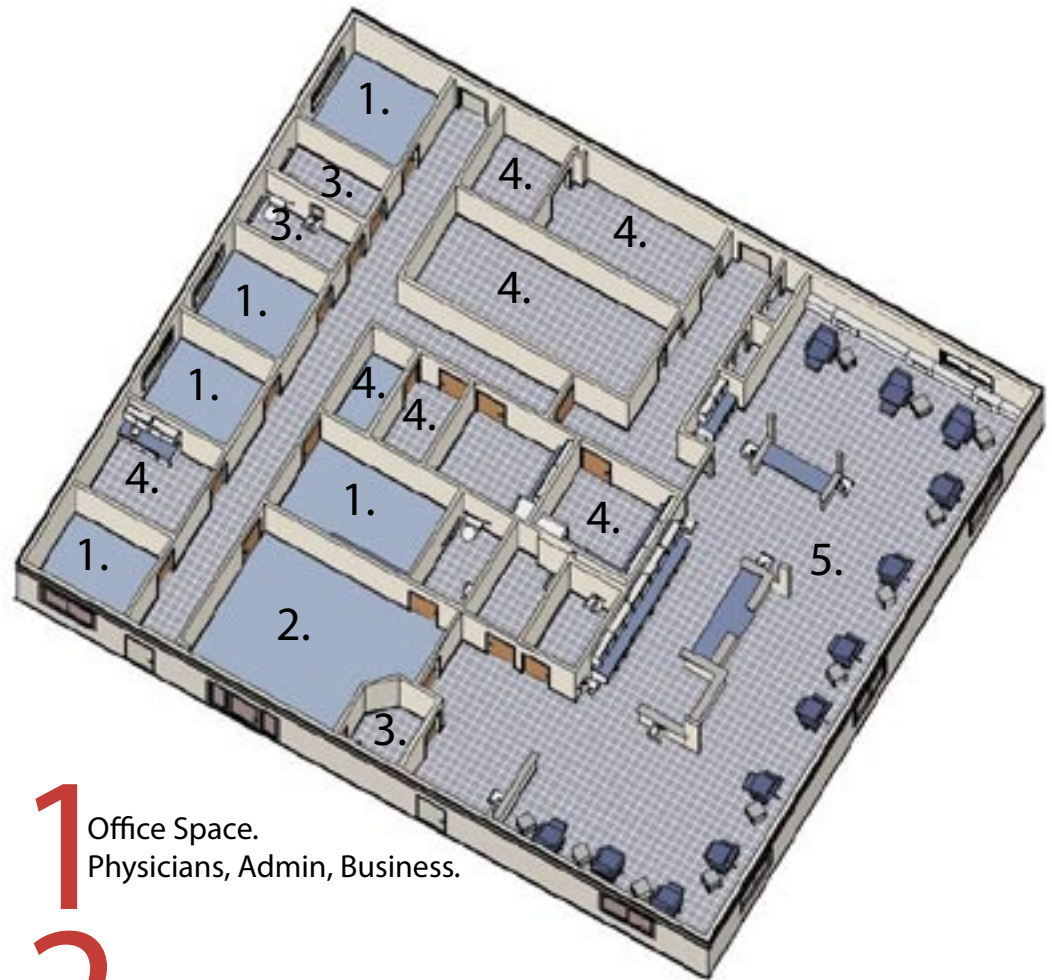

- 1** Office Space.  
Physicians, Admin, Business.
- 2** Patient Waiting Area.
- 3** Restroom Facilities.  
Staff, Public, and Patient Prep.
- 4** Medical Spaces.  
Exam Rooms, clean rooms,  
biomed, storage, bicarbonate.
- 5** Dialysis area and  
Nurses Station.

M E D I C A L

**Whitley Mfg. Co., Inc.**  
201 W. First St.  
So. Whitley, IN 46787  
(260) 723-5131  
[www.whitleyman.com](http://www.whitleyman.com)



- South Whitley, IN
- Rochester, IN
- Marysville, WA