

CASE STUDIES • CORPORATE

WHITLEY MANUFACTURING



FOR: Corporate Office
TYPE: Building & Addition
WITH: Williams-Scotsman

Williams-Scotsman is a leader in the sale and distribution of modular and mobile buildings for temporary and permanent use. Williams-Scotsman has offices throughout North America, serving a national clientele.

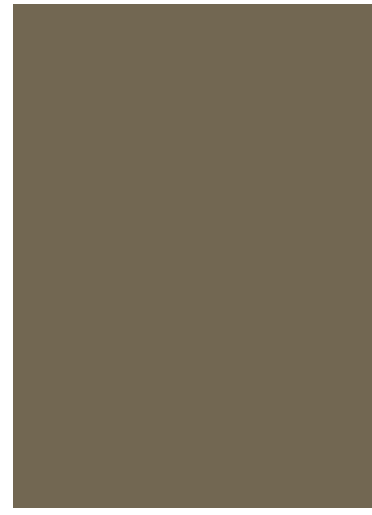

BUILDING FLOOR PLAN

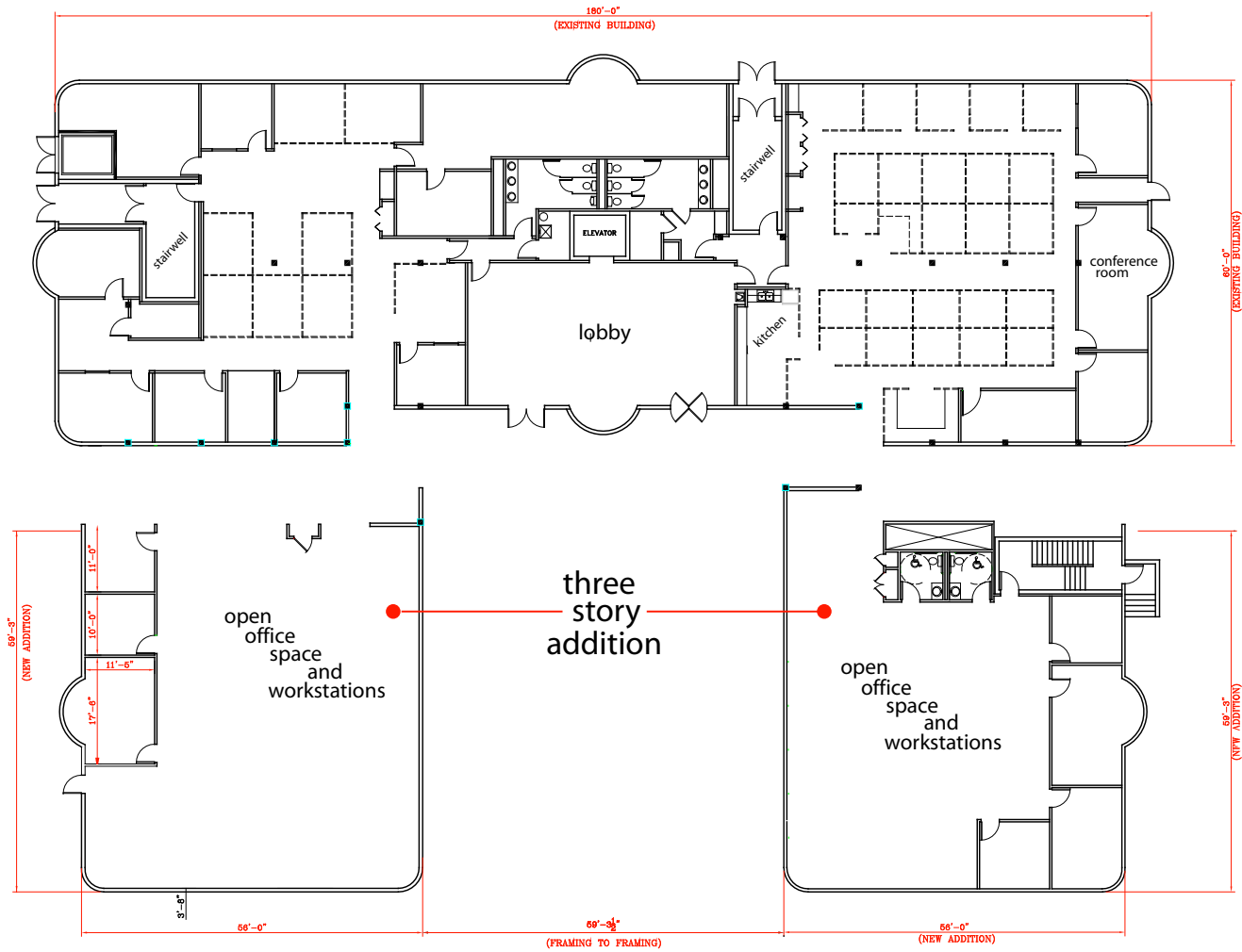

1ST OF 3 FLOORS IS SHOWN.

THEIR NEED

Williams had expanded operations significantly over the past 20 years. They had simply outgrown their original offices and needed additional space to service an ever-growing national network of clients. They required a modular building of the first quality to show the state-of-the-art possibilities offered with the modular system. The building would be seen on marketing materials, on their web site, and would be pointed to as the quintessential example of their product and the possibilities of modular construction.

OUR SOLUTION

The initial building was 35,000 square feet with a stucco exterior, a curved facade and bent windows. It presented a sleek, modern look to visitors. The foyer was finished in marble, chrome, tile, architectural glass and exotic woods. The interior presented an image of sophistication and permanence to further impress potential customers. Later, two additional wings were added to house a growing staff. These three story wings added an additional 35,000 square feet, for a total of appx. 70,000 square feet. Additional electrical work was included to power new computer and server technologies in the addition.

OFFICE

Whitley Mfg. Co., Inc.
 201 W. First St.
 So. Whitley, IN 46787
 (260) 723-5131
www.whitleyman.com



- South Whitley, IN
- Rochester, IN
- Marysville, WA