

**FIRST FLOOR**

|                      |                       |                               |  |  |
|----------------------|-----------------------|-------------------------------|--|--|
| OFFICES<br><b>35</b> | RESTROOMS<br><b>4</b> | INDUSTRY<br><b>Government</b> | SPECIAL FACILITIES<br>Archives • Training & Conference Rooms • Evidence Storage • Firearms Storage | SQ. FOOTAGE<br><i>appx.</i><br><b>15,000</b> |
|----------------------|-----------------------|-------------------------------|--|--|



**OFFICE BUILDINGS**  
BY WHITLEY MANUFACTURING

- Permanent or Relocateable
- Available in non-combustible construction types
- Multiple-story designs



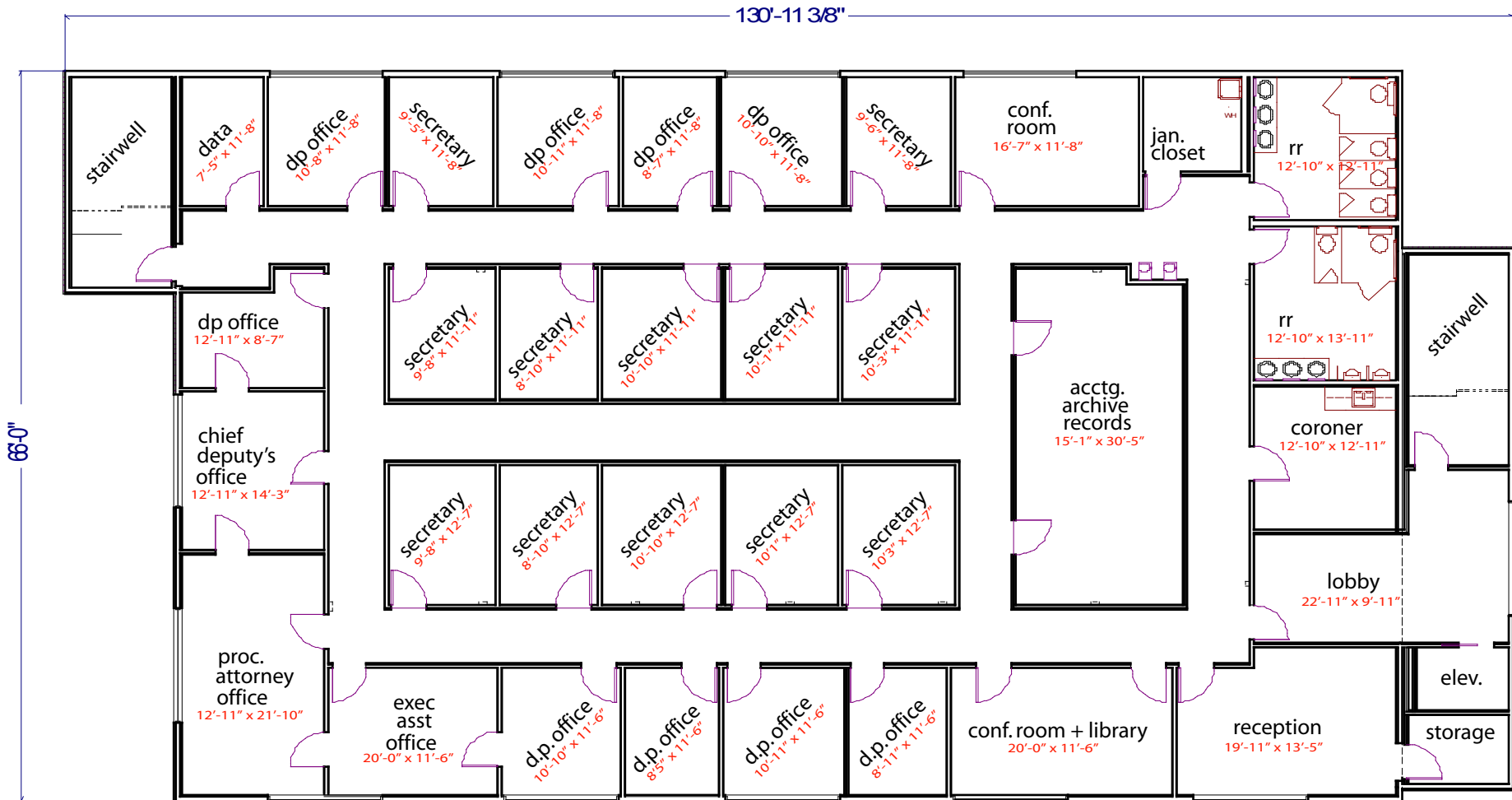

**SECOND FLOOR**

**EXTERIOR**



**Whitley Mfg. Co. Inc.**  
 • South Whitley, Indiana  
 • Rochester, Indiana  
 • Marysville, Washington  
 (260) 723-5131  
 www.whitleyman.com