



GUSTAVUS ADOLPHUS



Location Saint Peter, Minnesota

Partners Innovative Modular Solutions

Type Permanent Dormitory Facility

Size Total Structure: 11,600 sft.

Client Gustavus Adolphus is an undergraduate, residential, liberal arts college. Founded in 1862 by Swedish immigrants, it is the oldest Lutheran college in Minnesota. Gustavus offers a liberal arts education of recognized excellence, provided by a faculty who embody the highest standards of teaching & scholarship.

Their Need A typical Midwestern tornado destroyed a number of buildings on the campus early one spring. Among the destroyed buildings, was a large amount of residential housing. Campus leaders decided to replace the building in time for the coming school year. They wanted something permanent, attractive, substantial and inexpensive.

Our Solution Administrators of the college found their solution with Innovative Modular Solutions (a modular building distributor focused on custom building solutions). Within weeks of the tornado's strike, preliminary discussions were well under way. In April, plans were approved and off-site construction began at Whitley's Indiana facility. The building was shipped in sections during July and by August, the first students were able to move into the finished building.

Administrators and maintenance staff at Gustavus Adolphus remain very pleased with the quality and ease of maintenance of their building. The structure also met the school's strict budget demands.



Planning Phase. Meetings with the School and the Development of Design and Engineering Docs.

APRIL

Site development and foundations begin at the project site. Concurrently, construction of the modules is begun off-site at Whitley Manufacturing's construction facilities.

MAY

JUNE

Building sections are transported to site and set . University disruption is minimal as work takes place over the summer.

JULY

Building is finished. Students begin to move into the newly completed dormitory.

AUGUST

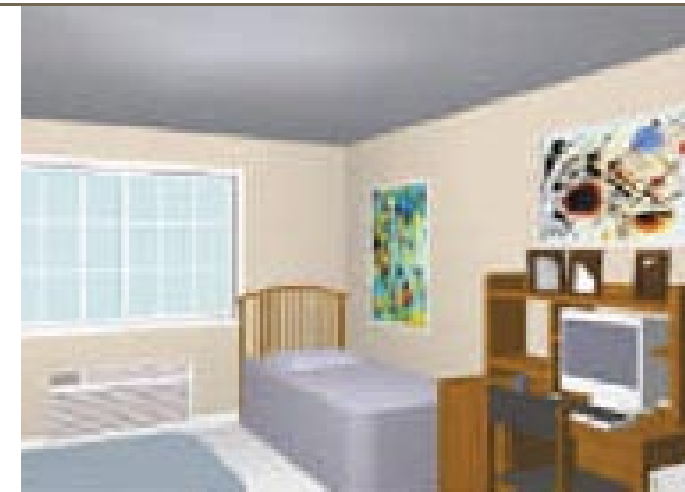
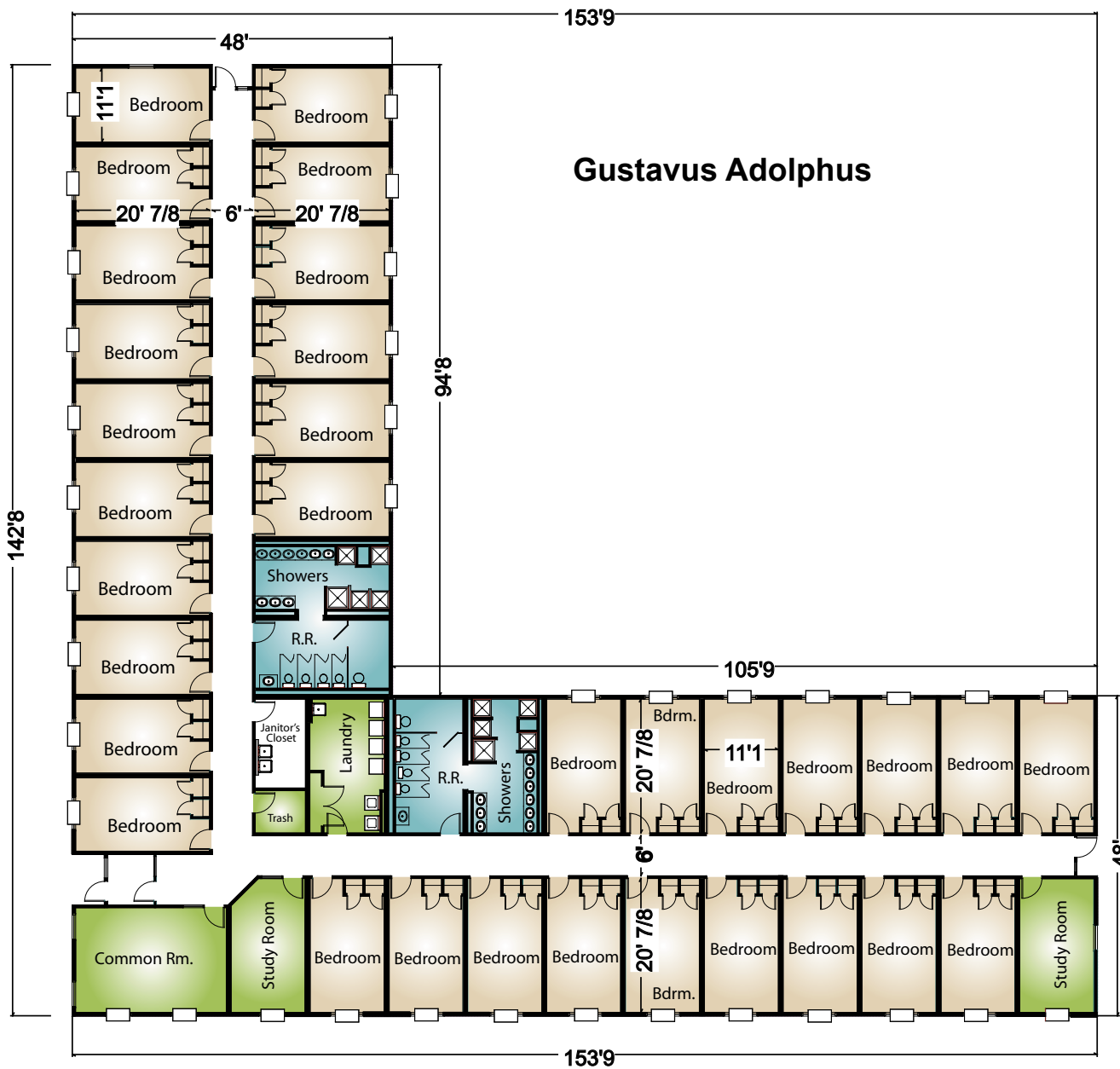

Whitley Mfg. Co., Inc.
 South Whitley, IN // Rochester, IN
 Marysville, WA
 (260) 723-5131
www.whitleyman.com

FEATURES

The building features a classical dormitory design with shared rooms and communal restroom and shower facilities.

Extra rooms were set aside as office space for R.A.s, study rooms, common areas, and waste disposal and laundry.

The building was designed to blend in with the existing campus structures in both finishes and aesthetics.

The structure was set in a matter of days, allowing the site to quickly become weathertight and secure.

By constructing the majority of the structure off-site, the campus was spared the disruption and danger of a large scale construction project.

By utilizing modern building techniques and completing site-work and building construction concurrently, Whitley Mfg. can cut typical construction timelines by 30-50% depending on the project - delivering a rapid return on construction investment.